

# 1335 W. 4th Street - Colby, KS

*This home is move-in ready. Two bedrooms, one bath home with many new updates. Appliances included plus the washer and dryer. Call Marilyn for more information.*



## \$67,000

Year Built: 1945  
Property Type: Residential  
Property SubType: Single Family Res.  
Main/Level 1: 848  
Approx. Square Feet: 848  
Lot Size: 50x98  
Approx. Lot Square Feet: 4,900  
Construction: Frame w/Siding

Style: Bungalow  
Stories: One Story  
Zoning: Residential  
County: Thomas  
Price/SqFt: \$79.01  
Heating: Central Heat  
Cooling: Central Air

Living Room:	17.4x13.6	Level: 1
Kitchen:	10.3x13.5	Level: 1
Bedroom 1:	8.9x8.7	Level: 1
Bedroom 2:	6.11x10.5	Level: 1
Bathroom 1:	7.6x4.8	Level: 1
Utility Room:	7.5x9.2	Level: 1

Patio/Deck: Deck  
Basement: Crawl Space  
Garage: Carport  
Fence: Privacy

Information has been obtained from sources deemed reliable; Broker does not guarantee information. Parties are welcomed to verify information through a professional.

# 71257

## Call Marilyn today to set up a showing!

*HomeLand*  
REALTY AUCTION  
(785) 462-8255  
www.homelandre.com



**Marilyn Meyer**  
Sales Associate

(785) 462-2703

Email: [mmeyer@homelandre.com](mailto:mmeyer@homelandre.com)

# Address: 1335 W. 4th Street - Colby, KS

**Legal Description:** All of Lot Eleven (11), Block One (1), Westwood Subdivision of Lots One (1), and Four (4) and part of Lots Two (2) and Three (3), Block One (1), Copeland and Van Petten's Addition to Gilmore and Larson's Addition to the City of Colby, Thomas County, KS

Included with the home: refrigerator, stove, hood, microwave, kitchen table, ceiling fans, washer and dryer. All personal property "AS IS"



- New carpet in two bedrooms
- New flooring and bathroom vanity
- Oak kitchen cabinets
- Central heat and air
- Dedicated utility room
- New roof May 2016
- Newer windows
- Privacy fence

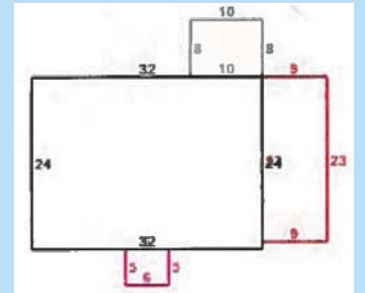

Average Utilities: Gas \$50.00 City \$83.76  
2015 Taxes \$779.70



[www.homelandre.com](http://www.homelandre.com)

**Call Marilyn at 785-462-2703**

Information has been obtained from sources deemed reliable; Broker does not guarantee information. Parties are welcomed to verify information through a professional.